

Punawale's *Most Awaited Launch*

PRESENTING



MAHARERA Received - P521000049095



You discover
the new definition of urban living with

Finely Crafted _____ — 2,3 & 4.5 BHK Homes

AT PRIME PUNAWALE

2 BHK – 685 to 772 Sq.Ft.

3 BHK – 875 to 987 Sq.Ft.

4.5 BHK – 1372 Sq.Ft.



Thought Behind The 4th Axis

You might have heard of X, Y, and Z axes, but we are here with **The 4th Axis**, a new dimension of living, a lifestyle that is never heard, seen, or thought of before.

The lifestyle you experience at **The 4th Axis** justifies this thought process.

Coincidentally, the **ideal intersection** of **DP Main Road** and **Kate Wasti Road** makes **The 4th Axis**, the new dimension of growth, uniqueness, and hassle-free experiences.

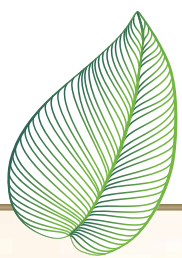



The
4th AXIS
PUNAWALE

A New Dimension Of Urban Living

Presenting a meticulously curated lifestyle that's unique, unconventional, never-seen-before, at Prime Punawale. A project which gives you endless forest views and will give you a chance to earn more.



Curated Lifestyle In A Serene Location

All the spacious residences at **The 4th Axis** are intricately crafted with meticulous layouts and lifestyle experiences. Here you live a serene lifestyle right next to reserved forests ensuring pleasant views all year round. The climate here is cleaner and cooler which further benefits the overall health of its residents.



16000 Sq.ft. Amenity Space



Near 40 Acres Of Reserved Forests



Exclusive Forest Deck With Lush Green Views



5 Mins From Wakad



7 Mins From Phoenix Marketcity, Wakad



30+ Premium Amenities

Punawale

The New Destination of Connectivity & Convenience

Being located in the most pristine neighborhood of PCMC, Punawale is a thriving locale with swift connectivity to every nook & corner of Pune.

This entire area has a diverse mix of IT & business hubs. Living in this locality, you can enjoy a hassle-free commute to Hinjawadi IT Hub, Wakad, Aundh, Baner, University Circle, Industrial Belts Of Pimpri-Chinchwad, Chakan, and Talegaon.

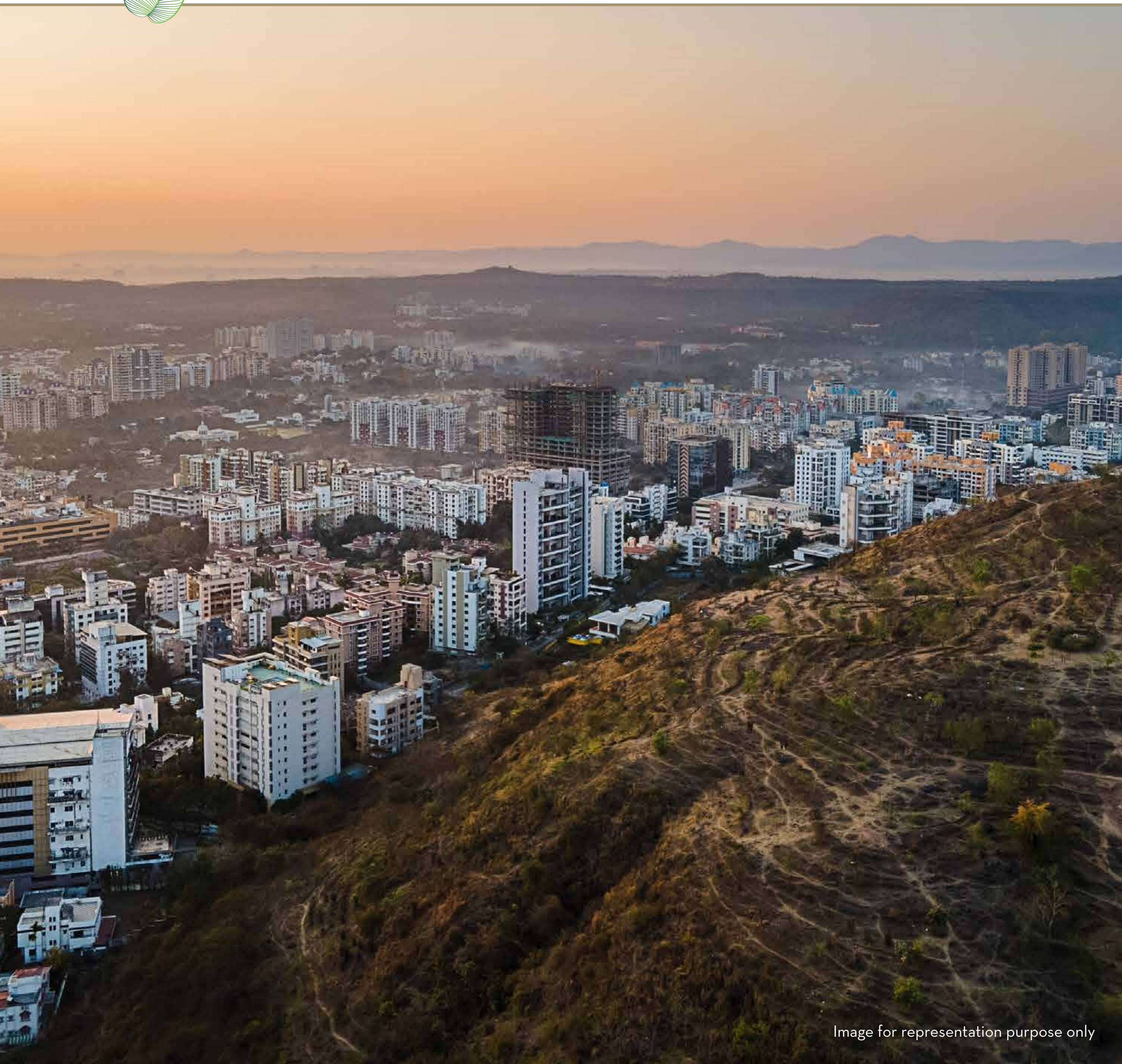
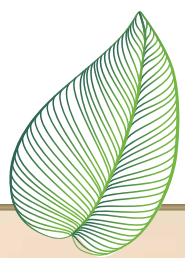



Hotels & Restaurants

- Sentosa Resort Park, Ravet - 10 mins
- Hotel Sayaji, Wakad - 10 mins
- Ginger, Wakad - 10 mins
- Courtyard Marriott, Hinjawadi - 15 mins



Key Business Zones

- Proposed World Trade Centre, Tathawade - 10 mins
- Proposed Panchshil Tech Park, Hinjawadi - 10 mins
- Balewadi High Street, Balewadi - 15 mins
- Rajeev Gandhi Infotech Park, Hinjawadi - 20 mins



Hospitals

- Ojas Multispeciality Hospital, Ravet – 10 mins
- Unique Multispeciality Hospital, Ravet - 10 mins
- Life Point Hospital, Wakad - 10 mins
- Aditya Birla Hospital, Chinchwad - 15 mins
- Lokmanya Hospital, Nigdi - 15 mins



Malls

- 18 Latitude – 2 mins
- Phoenix Marketcity, Wakad – 7 mins
- Reliance Superstore, Ravet – 10 mins
- D Mart, Ravet – 10 mins
- Decathlon, Wakad – 10 mins
- Elpro City Square Mall, Chichwad – 15 mins



Road Connectivity

- Pune Bangalore Highway – 5 min
- Mumbai Pune Expressway – 10 min
- Proposed Ring Road – 5 min
- Aundh Ravet BRTS Road – 10 min
- Old Mumbai Pune Highway – 15 min



Schools

- Euro School, Wakad – 10 mins
- SB Patil Public School, Ravet – 10 mins
- St. Ursula’s Schol, Akurdi – 10 mins
- St. Marys School, Nigdi – 15 mins
- City Pride School, Nigdi – 15 mins
- BK Birla Center for Education, Shirgaon – 20 mins



Higher Education Institutes

- Symbiosis Skills & Open University, Kiwale – 10 mins
- Indira Group of Institutes, Tathawade – 10 mins
- PCCOER - Pimpri Chinchwad College of Engineering and Research, Ravet – 15 mins
- PCCOE - Pimpri Chinchwad College of Engineering, Akurdi – 15 mins
- Dr. DY Patil College of Engineering & Management, Akurdi – 15 mins

Master Layout

Open Space Amenities:

- 1. Entrance Walkway With Creeper Trellis
- 2. Party Lawn
- 3. Rock Climbing Wall
- 4. Children’s Play Area
- 5. Senior Citizen Seat With Backrest
- 6. Neon Light Swing Area
- 7. Seating Patio With Feature Canopy
- 8. Swimming Pool
- 9. Toddler Pool
- 10. Pool Aquatic Therapy Walk
- 11. Sun Deck
- 12. Pantry Area
- 13. Buffet Serving Area
- 14. Multipurpose Space
- 15. Fully Equipped Gymnasium
- 16. Indoor Games Zone – Chess, Table Tennis, Carom
- 17. Outdoor Zumba And Aerobics Terrace
- 18. Flowering Tree Plantation
- 19. Fragrance Tree Plantation

Terrace Amenities:

- 1. Arrival Plaza With Feature Canopy
- 2. Alfresco Dining Deck
- 3. Extended High Tea Seatout
- 4. Outdoor Kitchen Space
- 5. Veg & Non-veg Barbeque Counters
- 6. Forest Viewing Deck
- 7. Star Gazing Nook
- 8. Clear Glass Parapet Wall
- 9. Physiotherapy Space With Forest View
- 10. Spa Space With Forest View
- 11. Roof Top Working Pods
- 12. Senior Citizen Area
- 13. Creeper Trellis
- 14. Acupressure Walkway
- 15. Rooftop Cardio Deck
- 16. Pilates Studio
- 17. Human Ludo
- 18. Yoga & Meditation Deck With Horizon View
- 19. Power Yoga Zone
- 20. Projector Screening Wall

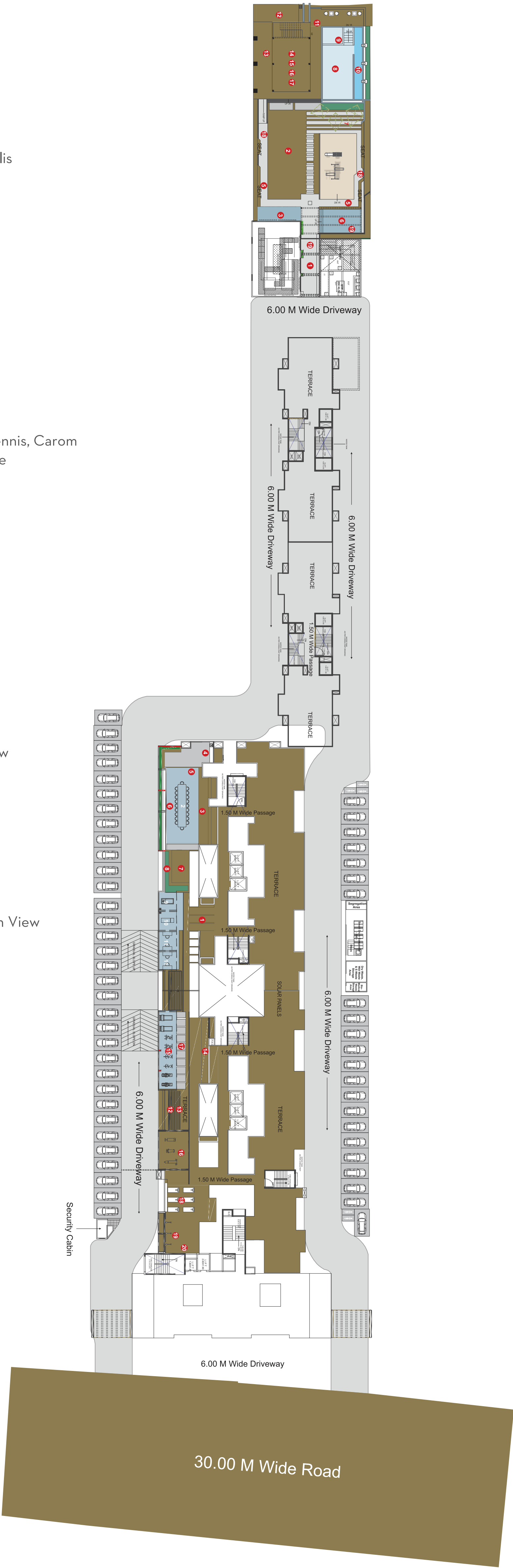

The New Benchmark Of *Thoughtful Layouts*

From the moment you enter **The 4th Axis**, you can't help but notice the detailing in every nook and corner of the project. Be it the walkways & entrance lobbies or the living rooms & balconies, every space here reflects precision and perfect consideration of comfort.

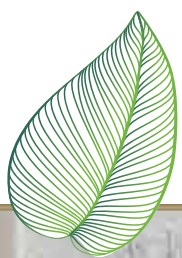

The New Definition of *Lifestyle Indulgences*

The amenities at **The 4th Axis** have been thoughtfully designed to provide you with an upgraded living experience. These indulgences are crafted for all age groups and have been curated to fulfil your fitness, wellness, recreation, and relaxation needs.

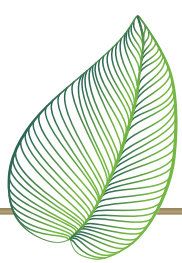

Open Space Amenities

- Entrance Walkway With Creeper Trellis
- Party Lawn
- Rock Climbing Wall
- Children's Play Area
- Senior Citizen Seat With Backrest
- Neon Light Swing Area
- Seating Patio With Feature Canopy
- Swimming Pool
- Toddler Pool
- Pool Aquatic Therapy Walk
- Sun Deck
- Pantry Area
- Buffet Serving Area
- Multipurpose Space
- Fully Equipped Gymnasium
- Indoor Games Zone-chess, Table-tennis, Carrom
- Outdoor Zumba And Aerobics Terrace
- Flowering Tree Plantation
- Fragrance Tree Plantation

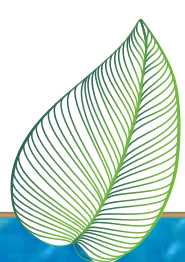



Image for representation purpose only

Clubhouse Amenities

- Multipurpose Area
- Fully Equipped Gymnasium
- TT Room
- Chess
- Carrom
- Outdoor Zumba And Aerobics
- Terrace

Lobby Amenities

- Designer Lobby
- Visitor's Seating
- Dedicated Reception Space
- Grand Entrance
- Concierge Desk
- Pool Table
- Foosball Table
- Creche

Project Facilities

- Designer Entry & Exit Gate
- Dedicated Security Cabin
- STP
- OWC
- UGWT
- Solar Panels
- Transformer
- Dg Backup
- Garbage Chute
- EV Charging Point
- Lift With Erd
- Energy Efficient LED Lighting
- Society Office
- Meter Room
- Driver/servant Room
- Driver/servant Room Toilet

Exclusive Forest Deck

A New Experience

The thoughtfully designed Forest Deck at **The 4th Axis** gives you an incomparable set of experiences while gazing at breathtaking views. From Yoga Zone with Horizon Views to WFH Pods to Barbeque Counters, every amenity here will elevate your every day for sure.

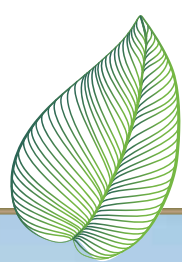

Terrace Amenities

- Arrival Plaza With Feature
- Canopy
- Alfresco Dining Deck
- Extended High Tea Sitout
- Outdoor Kitchen Space
- Veg & Non-veg Barbeque Counters
- Forest Viewing Deck
- Stargazing Nook
- Clear Glass Parapet Wall
- Physiotherapy Space With
- Forest View
- Spa Space With Forest View
- Rooftop Working Pods
- Senior Citizen Area
- Creeper Trellis
- Acupressure Walkway
- Rooftop Cardio Deck
- Pilates Studio
- Human-sized Ludo
- Yoga & Meditation Deck With
- Horizon View
- Power Yoga Zone
- Projector Screening Wall



The New Dimension Of *Fine Craftsmanship*

Right from flooring to electricals to sanitary ware, the luxurious residences at **The 4th Axis** are equipped with premium specifications, including branded fittings from **TOTO & Grohe**. Attention to detail and acute understanding of comfort has been ensured throughout the project to enable a chic living experience.



Unmatched Specs To Suit Your Everyday Comfort



Master Bedroom

- Cross Ventilation Designed For Better Iaq
- Ac Point
- Planned Space For Study Table With Charging Point
- Usb Point
- Mobile Charging Points For Him And Her On Both Sides Of The Bed
- Tv Point To Enjoy Your Ott
- Bed Direction As Per Vastu
- Planned Space For Dressing Tables
- Huge Wardrobe Space
- Sliding Window Door Of Maximum Size For Better Space Utilisation
- Internal Grills For Safety
- Adequate Electrical Points
- Door With Premium Locks From Europa Or Equivalent Make

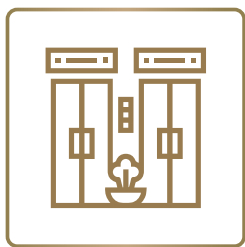

Entrance Lobby

- East - West Entry In 100% Flats As Per Vastu
- Dedicated Space For Shoe Racks, Umbrellas, Helmets, Etc.
- Wide Main Door Opening For Easy Material Movement
- Pre-installed Hooks On Main Door For Toran



Kids Bedroom

- Activity Wall For Black Board/ Screen / Ladder Play
- Planned Space For Study Table With Charging Point
- Biggest Size Sliding Window With 450mm Sil For Extra Safety
- Internal Grills For Safety
- Adequate Electrical Points
- Door With Premium Locks From Europa Or Equivalent Make



Common Bathroom

- Big Height Multifloored Trap For Avoiding Foul Smell
- Provision For Exhaust Fan
- Drop For Wet Dry Area
- Window Above Wc For Planned Aesthetics
- Outdoor Common Basin For Guests And Dining Area
- Doors With Premium Locks From Europa Or Equivalent Make



Living Room

- Dedicated Tv Viewing Space
- Sliding Full Window For Max Lighting And Ventilation With Better Air Quality Index
- Options In L and Vertical Living Units
- Low Level Charging Points Near Seating Areas
- Provision For Chandelier In Living Room And Dining Ceiling
- Specially Panned Temple Corner With Vastu



Balcony

- Space To Install Resistance Bands On The Wall Of Terrace For Your Daily Workout
- Updated Roof Corner Drain System For Clear Ceiling And Deck Area In The Terrace
- Space For Planters And Vertical Gardens
- Light Point , Charging Point And, Mood Lighting And Other Utilities
- Space For Daily Exercise, Meditation And Yoga Space For Pets' Corner
- Sit Out For Family Time
- Designer Railings In Terrace
- Powder Coated Premium Aluminum Section With Mosquito
- Nets & Glass Paneled Shutter In Terrace



Dinning

- Vdp Video Door Phone For Safety And Security
- Ac Point
- Cross Ventilation Designed For Better Iaq- Indoor Air Quality
- Wall Space For Crockery Shelf Or Mini Library



Master Bathroom

- Solar Water Supply With Concealed Cock
- Special Granite Counter For Utility Storage Of Toothbrush, Shampoo, Etc.
- Provision For Exhaust Fan
- Doors With Premium Locks From Europa Or Equivalent Make
- Hair Dryer Points And Shaver Point
- Laundry Space Below The Wash Basin
- Special P Traps For Basins
- Drop For Wet Dry Area
- Concealed Flush Valves In Bathrooms
- Premium 2x2 Grid Ceiling Of Everest Or Equivalent Make
- Electrical Point For Geyser/ Water Heater With Dedicated Space
- Chrome Finish Water Drain Cover
- Big Size Multifloor Trap To Avoid Foul Smell

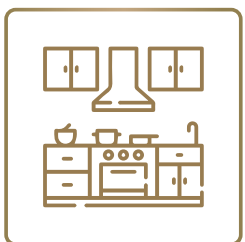

Kitchen

- Kitchen Sink Designated With Dedicated Space For Keeping Scrubber Soap Bottle Tec
- Electrical And Water Supply Point Above Sink For Water Purifier
- Space For L Shape Platform
- Longest In Space 11 Ft Single Kitchen Platform
- Planned Electrical Points For Mixer Toaster Hotplate Fridge Microwave
- Space To Dry Utensils Above Sink
- Utility Item Storage Space Below Sink
- P Trap In Sink For Avoiding Foul Smell
- Space For Dish Washer Above Washing Machine
- Good Size Window For Light Ventilation
- Provision For Exhaust Fan Point
- Optional Additional Modification For Separate Servant Entry For Maids To Kitchen

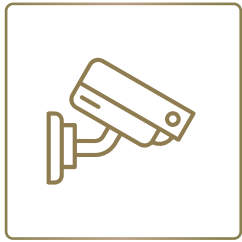

Security

- ▀ CCTV For Exterior Common Areas
- ▀ Entrance Gate Boom Barrier



RCC

- ▀ Earthquake Resistant RCC Framed Structure



Flooring & Dado

- ▀ Master Bedroom: Premium Size 1200 X 600 Wooden Tiles
- ▀ Entire Flat: Premium Size 1200 X 600 Tiles
- ▀ Tastefully Designed Moroccan Style Terrace Tiles For The Deck
- ▀ Anti-skid Tiles In Toilets

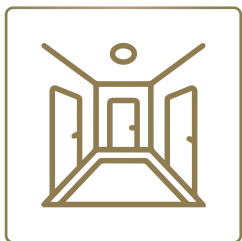

Passage

- ▀ Loft In Space For Inverter And Storage
- ▀ Inverter Backup For Light And Fan Points
- ▀ Strategically Located Router Point In Center Of The Home



Electrification

- ▀ Concealed Wiring With Polycab/RR Cabel Or Equivalent
- ▀ Adequate Electrical Points In All Rooms
- ▀ Premium Modular Switches, MCB, RCCB Of Legrand, Schneider Or Equivalent
- ▀ Earth Leakage Circuit Breaker



Paints

- ▀ Internal Wall - Emulsion Paint Or Equivalent
- ▀ External Wall - Apex Acrylic Paint Or Premium Acrylic

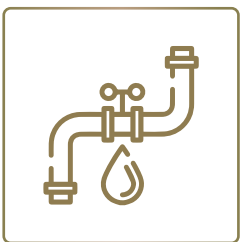

Plumbing

- ▀ Concealed Plumbing Of Premium Grade From Supreme Industries Or Equivalent Make
- ▀ Chrome Plated Bathroom Fittings And Fixtures From German Make Grohe / Equivalent Make In Bathroom, Toilets & Kitchen
- ▀ Sanitary Ware: Premium Sanitary Ware From Japanese Make TOTO/ Equivalent Make
- ▀ Updated, Easy To Maintain Under Slung Plumbing System

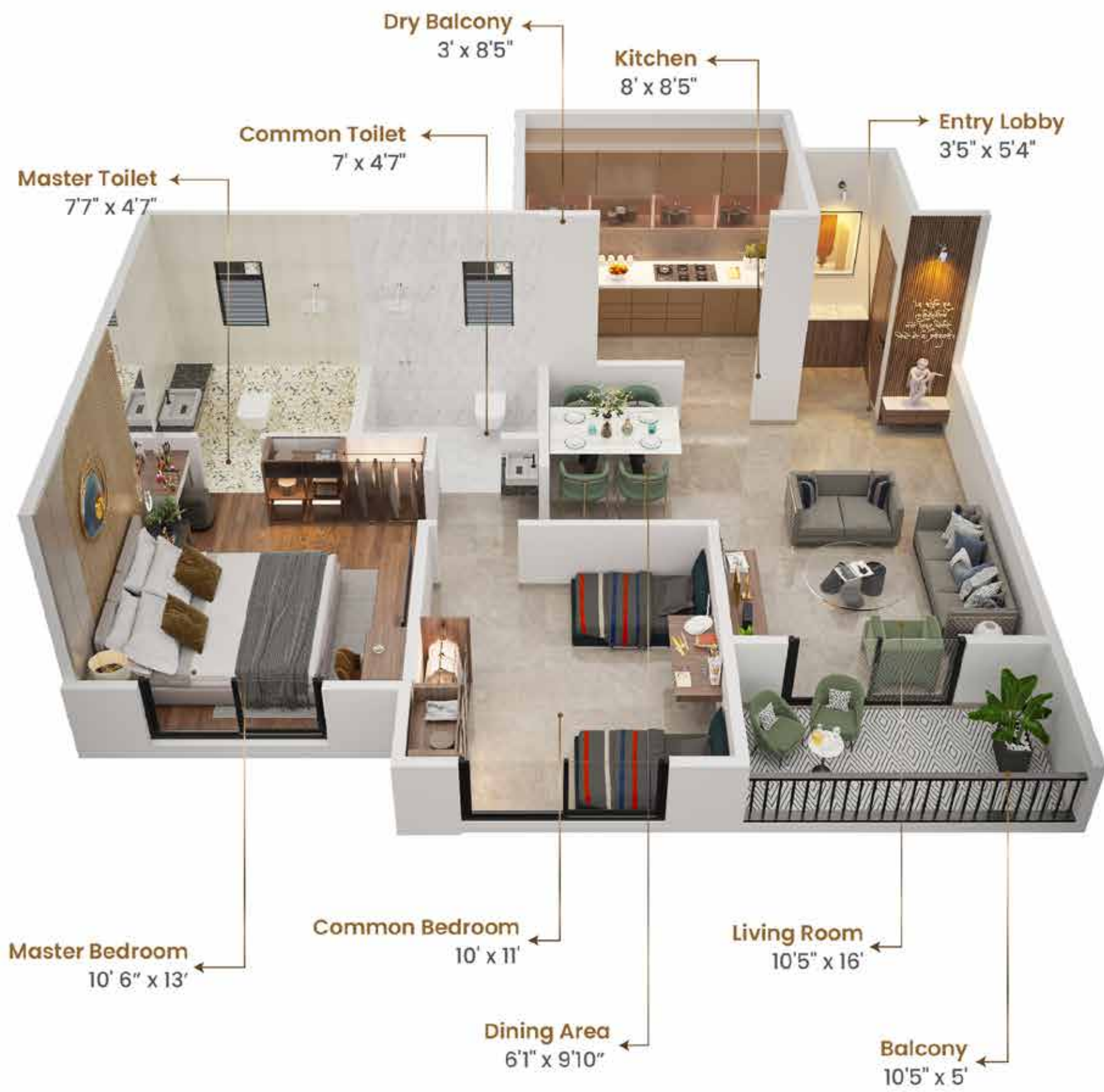

2 BHK – 758 Sq. Ft.

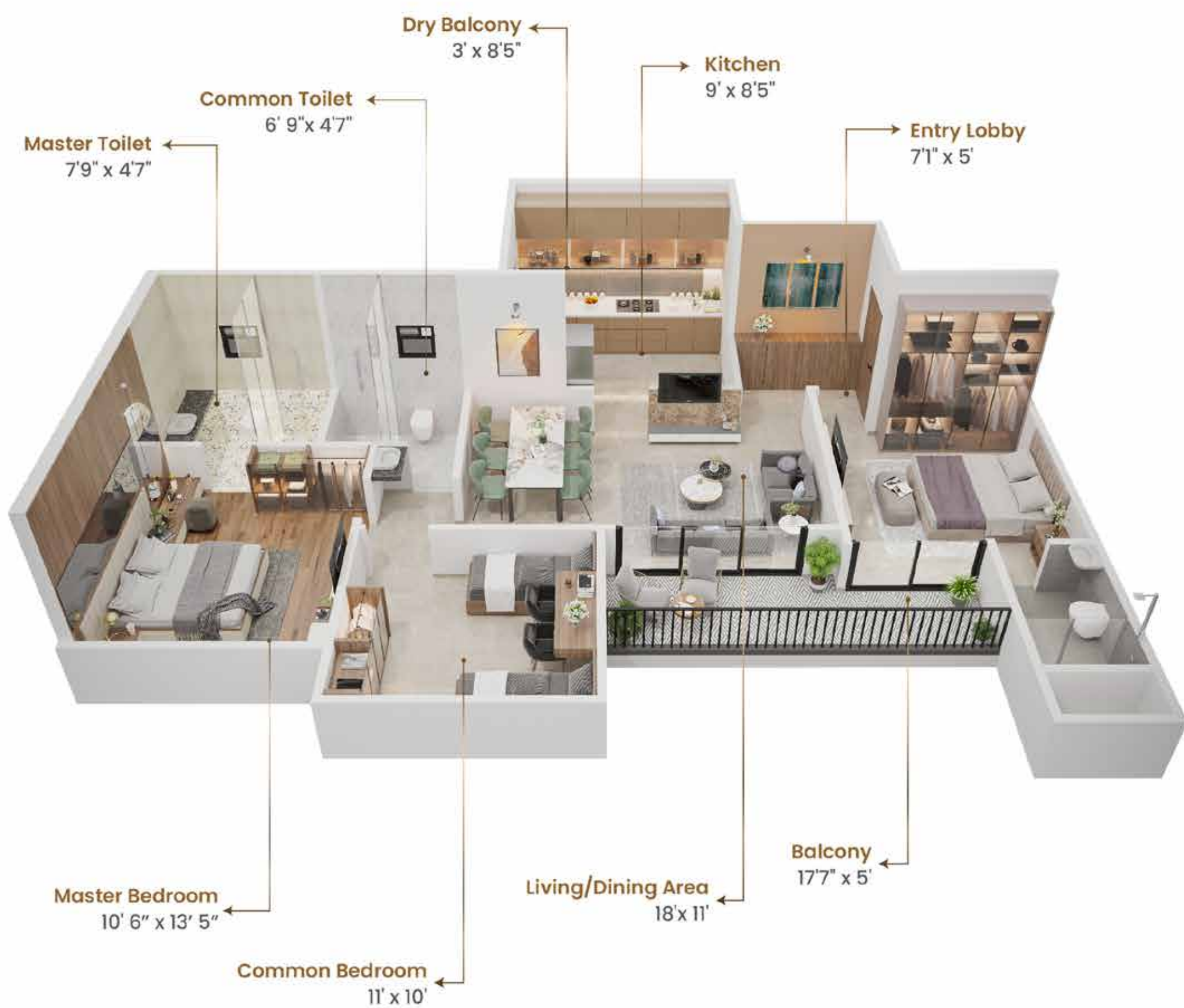

3 BHK – 970 Sq. Ft.

B - First Floor Plan

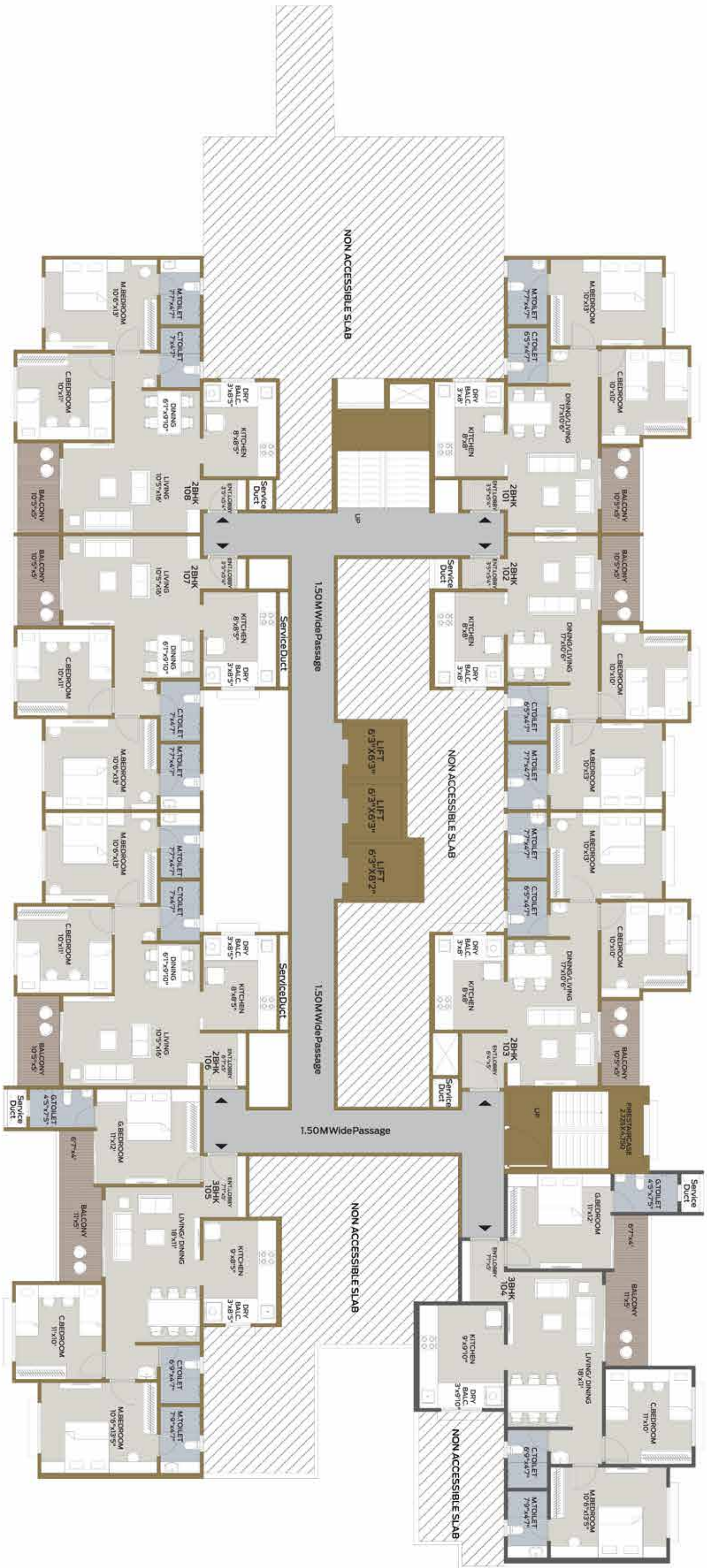

| CARPET AREA STATEMENT OF B BUILDING | | | | | | | |
|-------------------------------------|--------------|-------------------------|------------------|------------------------|----------------|-------------------------|--------------------------|
| 1ST FLOOR | | | | | | | |
| BUILDING NO. | FLOOR NUMBER | FLAT NAME | APARTMENT NUMBER | CARPET AREA/FLAT(sq.m) | BALCONY (sq.m) | TOTAL CARPET AREA(sq.m) | TOTAL CARPET AREA(sq.ft) |
| B BUILDING | 1ST FLOOR | 2 BHK DOWNTOWN | 101,102 | 59.54 | 4.08 | 63.62 | 685 |
| | | 2 BHK DOWNTOWN ULTRA | 103 | 60.97 | 4.08 | 65.05 | 700 |
| | | 3 BHK FOREST DECK | 105 | 82.73 | 7.39 | 90.12 | 970 |
| | | 2 BHK FOREST DECK ULTRA | 106 | 66.96 | 4.76 | 71.72 | 772 |
| | | 2 BHK FOREST DECK | 107,108 | 65.64 | 4.76 | 70.40 | 758 |
| | | 3 BHK DOWNTOWN | 104 | 84.28 | 7.39 | 91.67 | 987 |

B - Typical Floor Plan

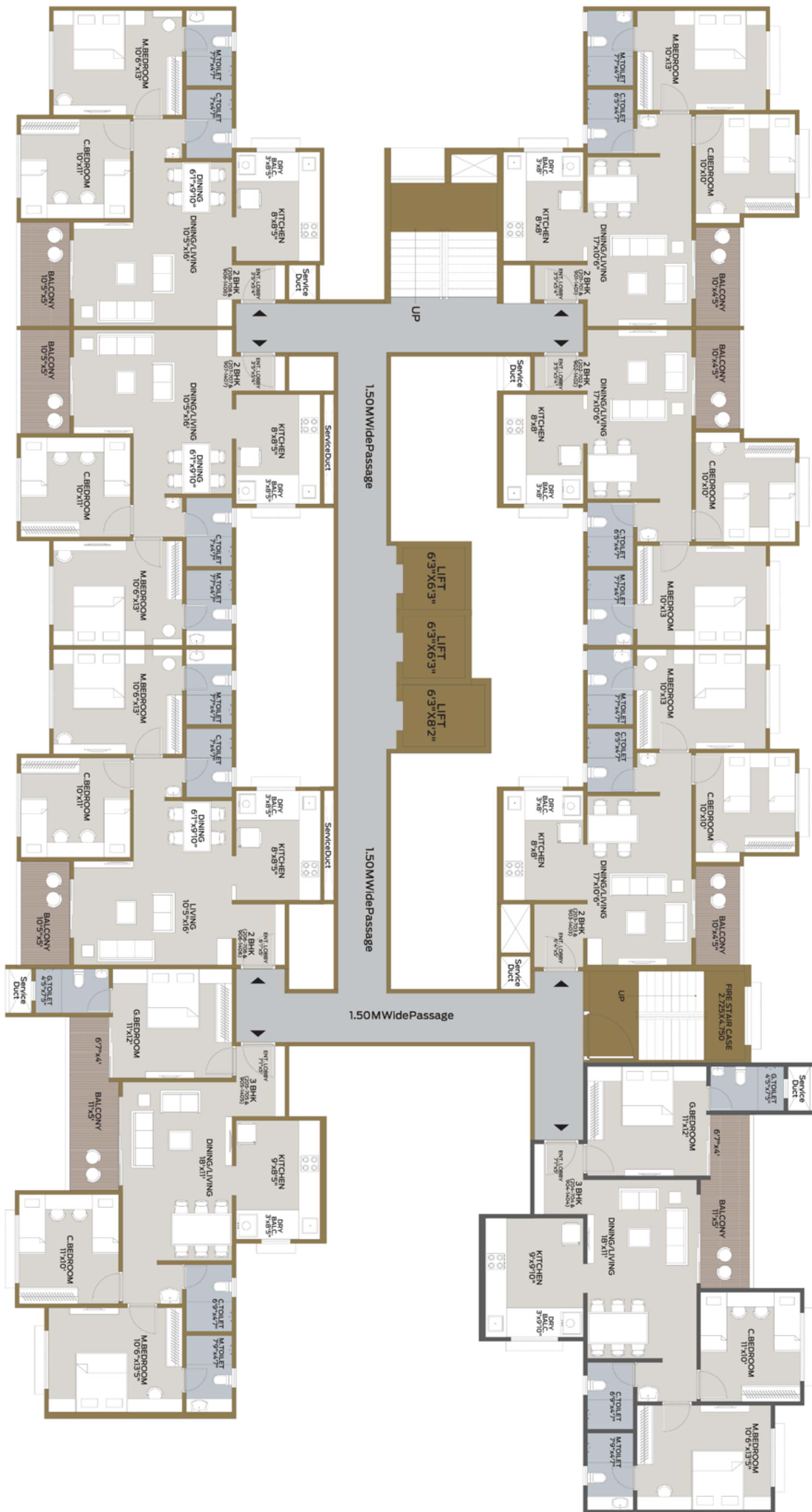

| CARPET AREA STATEMENT OF B BUILDING | | | | | | | |
|--|--|----------------------------|---|------------------------|----------------|-------------------------|---------------------------|
| 2 nd ,3 rd ,4 th ,5 th ,6 th ,7 th ,9 th ,10 th ,11 th ,12 th & 14 th Floor | | | | | | | |
| BUILDING NO. | FLOOR NUMBER | FLAT NAME | APARTMENT NUMBER | CARPET AREA/FLAT(sq.m) | BALCONY (sq.m) | TOTAL CARPET AREA(sq.m) | TOTAL CARPET AREA (sq.ft) |
| B BUILDING | 2 nd ,3 rd 4 th 5 th ,6 th 7 th ,9 th 10 th ,11 th 12 th & 14 th Floor | 2 BHK DOWNTOWN | 201,301,401,501,601,701,901,1001,1101, 1201,1401,202,302,402,502,602,702,9 02,1002,1102,1202,1402 | 59.54 | 4.08 | 63.62 | 685 |
| | | 2 BHK DOWNTOWN ULTRA | 203,303,403,503,603,703,903,1003,11 03,1203,1403 | 60.97 | 4.08 | 65.05 | 700 |
| | | 3 BHK FOREST DECK | 205,305,405,505,605,705,905,1005,11 05,1205,1405 | 82.73 | 7.39 | 90.12 | 970 |
| | | 2 BHK FOREST DECK ULTRA | 206,306,406,506,606,706,906,1006,11 06,1206,1406 | 66.96 | 4.76 | 71.72 | 772 |
| | | 2 BHK FOREST DECK | 207,307,407,507,607,707,907,1007,11 07,1207,1407,208,308,408,508,608,7 08,908,1008,1108,1208,1408 | 65.64 | 4.76 | 70.40 | 758 |
| | | 3 BHK DOWNTOWN | 204,304,404,504,604,704,904,1004, 1104,1204, 1404 | 84.28 | 7.39 | 91.67 | 987 |

B - Refuge Floor Plan

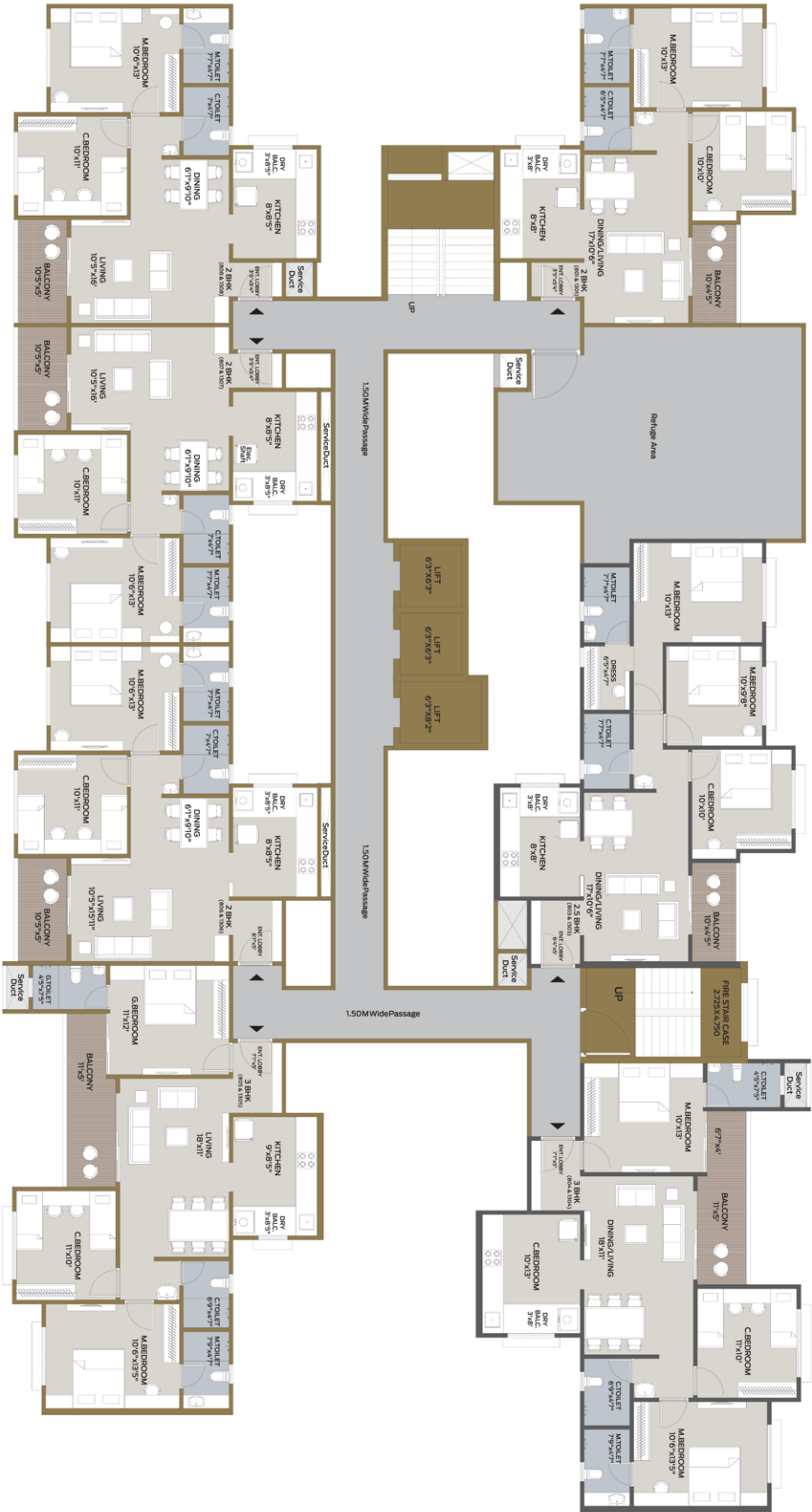

| CARPET AREA STATEMENT OF B BUILDING | | | | | | | |
|-------------------------------------|--------------|-------------------------|------------------|------------------------|----------------|-------------------------|--------------------------|
| 8TH & 13TH FLOOR | | | | | | | |
| BUILDING NO. | FLOOR NUMBER | FLAT NAME | APARTMENT NUMBER | CARPET AREA/FLAT(sq.m) | BALCONY (sq.m) | TOTAL CARPET AREA(sq.m) | TOTAL CARPET AREA(sq.ft) |
| B BUILDING | 1ST FLOOR | 3 BHK COMFORT | 803,1303 | 77.21 | 4.08 | 81.29 | 875 |
| | | 2 BHK DOWNTOWN | 801,1301 | 59.54 | 4.08 | 63.62 | 685 |
| | | 3 BHK FOREST DECK | 805,1305 | 82.73 | 7.39 | 90.12 | 970 |
| | | 2 BHK FOREST DECK ULTRA | 806,1306 | 66.96 | 4.76 | 71.72 | 772 |
| | | 2 BHK FOREST DECK | 807,1307 | 65.64 | 4.76 | 70.40 | 758 |
| | | 3 BHK DOWNTOWN | 804,1304 | 84.28 | 7.39 | 91.67 | 987 |

2 BHK Forest Deck Ultra



| Unit Plan 772 SQ.FT |
|---------------------------|
| Master Bedroom 10'6"X13' |
| Master Bathroom 7'7"X4'7" |
| Common Bedroom 10'X11" |
| Common Bathroom 7'X4'7" |
| Living Room 10'5"X16' |
| Dining 6'1"X9'10" |
| Kitchen 8'X8'5" |
| Balcony 10'5"X5' |

2 BHK - Forest Deck



| Unit Plan 758 SQ.FT |
|---------------------------|
| Master Bedroom 10'6"X13' |
| Master Bathroom 7'7"X4'7" |
| Common Bedroom 10'X11" |
| Common Bathroom 7'X4'7" |
| Living Room 10'5"X16' |
| Dining 6'1"X9'10" |
| Kitchen 8'X8'5" |
| Balcony 10'5"X5' |

2 BHK - Downtown Ultra



| Unit Plan 700 SQ.FT |
|---------------------------|
| Master Bedroom 10'X13' |
| Master Bathroom 7'7"X4'7" |
| Common Bedroom 10'X10" |
| Common Bathroom 6'5"X4'7" |
| Living + Dining 17'X10'6" |
| Kitchen 8'X8' |
| Balcony 10'X4'5" |

2 BHK Downtown



| Unit Plan 685 SQ.FT |
|---------------------------|
| Master Bedroom 10'X13' |
| Master Bathroom 7'7"X4'7" |
| Common Bedroom 10'X10" |
| Common Bathroom 6'5"X4'7" |
| Living + Dining 17'X10'6" |
| Kitchen 8'X8' |
| Balcony 10'X4'5" |

3 BHK - Downtown



| Unit Plan 987 SQ.FT |
|----------------------------|
| Master Bedroom 10'6"X13'5" |
| Master Bathroom 7'9"X4'7" |
| Guest Bedroom 11'X12" |
| Guest Bathroom 4.5"X7.5" |
| Common Bedroom 11'X10" |
| Common Bathroom 6'9"X4'7" |
| Living + Dining 18'X11' |
| Kitchen 9'X9'10" |
| Balcony 17'7"X5' |

3 BHK - Forest Deck



| Unit Plan 970 SQ.FT |
|----------------------------|
| Master Bedroom 10'6"X13'5" |
| Master Bathroom 7'9"X4'7" |
| Guest Bedroom 11'X12" |
| Guest Bathroom 4.5"X7.5" |
| Common Bedroom 11'X10" |
| Common Bathroom 6'9"X4'7" |
| Living + Dining 18'X11' |
| Kitchen 9'X8'5" |
| Balcony 17'7"X5' |

4.5 BHK - Downtown



| Unit Plan 1372 SQ.FT |
|-----------------------------|
| Master Bedroom 10'X13' |
| Master Bathroom 7'9"X4'7" |
| Guest Bedroom 10'X10' |
| Guest Bathroom 6'5"X4'7" |
| Common Bedroom 10'X10' |
| Common Bathroom 6'5"X4'7" |
| Living + Dining 27'4"X10'6" |
| Kitchen 12'X8' |
| Balcony 9'10"X4'5" |
| Balcony 9'10"X4'5" |



Crafting Homes

Full Of Life!

With a portfolio of quality residential projects like Ace Almighty & Ace Aurum. Lifecraft is playing a magnificent role in embellishing the skylines of Pune.

We are known for our quality work, innovative techniques and customer-centric approach. We are committed to delivering the best that our customers expect. We have earned enormous trust and goodwill in residential & commercial projects.

Here's our contribution in making you craft a beautiful life.

With so many unparalleled experiences and unobstructed views, **The 4th Axis** is the home you were looking for!

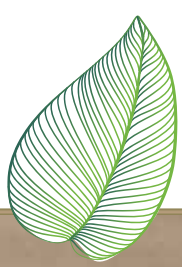

Thank You